

Garfield Road Wimbledon, SW19 8SB

£400,000 Leasehold



A well presented, one bedroom, Victorian ground floor flat with a large garden and no onward chain located on this popular road in Poets close to Garfield Park and various transport links. There is a spacious kitchen with space for a dining table and access to the low maintenance garden, a double bedroom, family bathroom and cosy living room to the front. This is an ideal first time purchase or investment.

Garfield Road, SW19

Approximate Gross Internal Area :- 45 sq m / 484 sq ft

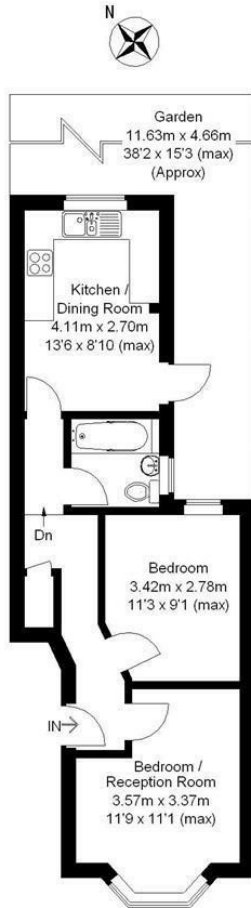

This floor plan is for representation purposes only and is not drawn to scale. Whilst every attempt has been made to ensure of the accuracy of the plan measurements of doors, windows and rooms are approximate only and should be checked before making any decisions reliant upon them.
Copyright Bespokeplans.co.uk 2011
(ID15525)

- Victorian One Bedroom Flat
- Large Garden
- Kitchen with Space for a Dining Table
- No Onward Chain
- Close to Various Transport Links
- Popular Road Close to Garfield Park
- Ideal First Purchase
- EPC Rating D

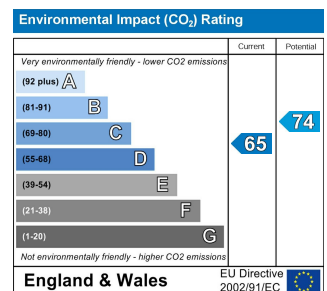
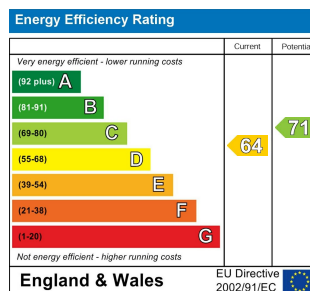

For Free Mortgage Quote and Best Mortgage Rates, call an Ellisons Mortgage Advisor on 020 8944 9494



Although these particulars are believed to be correct, their accuracy is not guaranteed and they do not form part of any contract.

Celebrating 30 years of successful Sales and Lettings in Merton

